

ISS	ZONE	DESCRIPTION/PER REQUEST DATE
4	A-7	B1121A1-D43-ND3G-50 WAS 44-290-A03G-50 W/A/08-08-01*

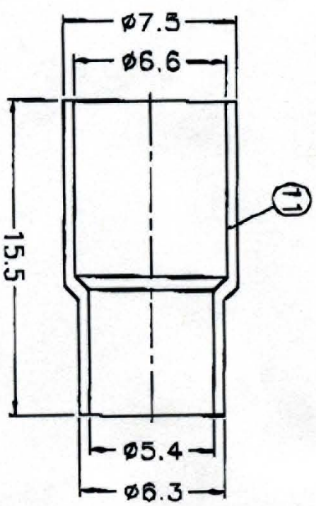

NOTES: FINISH (PLATING THICKNESS IN MICRO-INCHES)
 1. BRASS PER QQ-B-626
 2. BRASS PER QQ-B-613
 3. NICKEL PL. 100 MIN THICK OVER COPPER STRIKE
 4. NICKEL PL. 200 MIN THICK OVER COPPER STRIKE
 5. GOLD PL. 3 MIN THICK OVER NICKEL PL. 100 MIN THICK OVER COPPER STRIKE

NO.	DESCRIPTION	MATERIAL	FINISH	QTY	DRAWING NO.
1	SHELL	NOTE 1	NOTE 3	1	85C000-1-8
2	BODY	NOTE 1	NOTE 3	1	85C000-2-56/39
3	INSULATOR	DELBIN	NATURAL	1	85C000-3-50-A
4	GASKET	RUBBER	RED	1	GS-115/8X15
5	RETAINER RING	NOTE 1	NOTE 3	1	85C000-5
6	SPRING	SKS	NOTE 4	1	85C000-6
7	WASHER	NOTE 2	NOTE 3	1	WS-128/9X08
8	CONTACT PIN	NOTE 1	NOTE 5	1	85C000-8-25/076
9	CONTACT PIN	NOTE 1	NOTE 5	1	85C000-8-25/09
10	FERRULE	NOTE 1	NOTE 3	1	FR-75/68X127
11	FERRULE	NOTE 1	NOTE 3	1	FR-75/66-63/54 X155

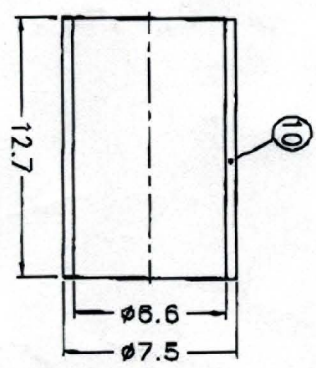
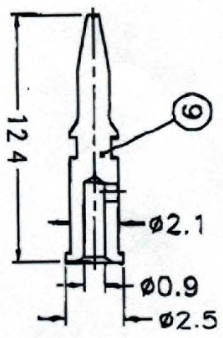
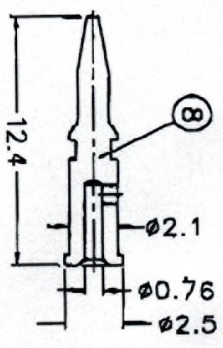
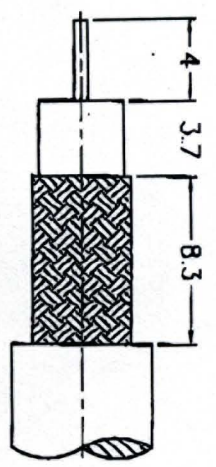
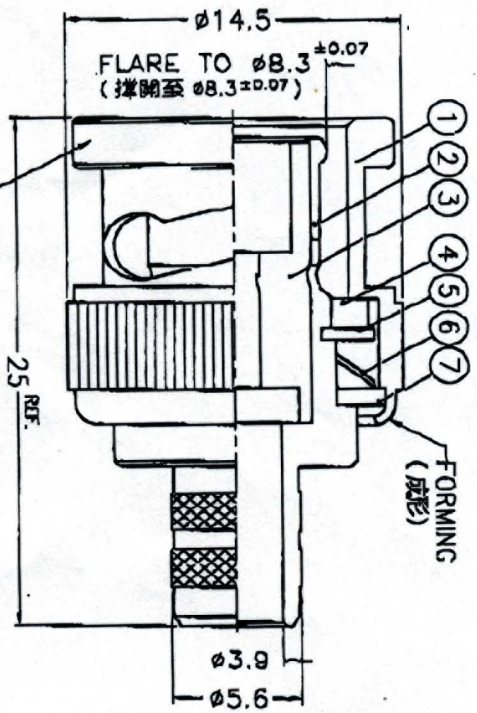

UNLESS OTHERWISE SPECIFIED TOLERANCES
0.5-8 = ±0.2
6-30 = ±0.4
30-120 = ±0.6
120-315 = ±1
315-1000 = ±1.5
1000-2000 = ±2.4

PART NO.		DRAWINGS ARE IN MILLIMETERS	
APPROVED	DATE	CHECKED	DATE
	08-08-01*		08-08-01*
TITLE		DRAWING NO.	
BNC CRIMP PLUG		44-290	
200 Hillsboro Street, Office: 919-693-1561		FILE NO. F:\DWG\B1121A1\043\50\ND3G	
Oxford, NC 27565		DRAWING NO.	
		DATE	
		08-08-01*	